

**APPENDIX "B"**  
**BVGCD AFFIDAVIT FORM**

**AFFIDAVIT OF LEGAL RIGHT TO PRODUCE GROUNDWATER**

(Entity Form)

**BEFORE ME**, the undersigned authority, on this day personally appeared Bernadette Priestly, who being duly sworn on her oath, says and deposes as follows:

"My name is Bernadette C. Sloat aka Bernadette Priestly. I am the Trustee (title) of The Bernadette C. Priestly Trust (name of entity) (hereinafter referred to as the "Applicant"). I have been authorized by The Trust (name of entity) to give this affidavit. I am of sound mind, over eighteen (18) years of age, and have never been convicted of a felony or of a crime involving moral turpitude. My address is 16000 Oleta Ln., Sugarland, Texas 77498. I have personal knowledge of the facts stated herein, and they are true and correct.

1. I am submitting to the Brazos Valley Groundwater Conservation District ("District") an application for a drilling and/or operating permit on behalf of the Applicant for a water well located at \*See Attached.
2. Applicant has the legal authority to produce the groundwater associated with the land surface and the permit application for the well listed in #1 above, as required by District Rule 7.1(c).
3. Exhibit A, attached hereto, is the map that identifies the water rights to be legally controlled by the Applicant under District Rule 7.1(c) for the well listed in #1 above.
4. I have provided to the District documents that prove Applicant's right to own, control, or produce the groundwater rights associated with the permit application for the well listed in #1 above, as required by District Rule 7.1(c).
5. I have provided to the District documents, if any, that fully evidence all transfer(s) of Applicant's right to own, control, or produce the groundwater rights to another person/entity that are associated with the land surface and the permit application, as required by Rule 7.1(c). And I understand that I am required to provide such transfer documents as they occur in the future.
6. I understand that a permit may be amended or revoked if the groundwater rights or right to produce, related to a permit under Rule 7.1(c), are legally transferred to another person/entity.

**FURTHER AFFIANT SAYETH NOT."**

Signed Bernadette Sloat  
Bernadette Sloat, Individually  
and as Trustee of the Bernadette C. Priestly Trust  
Authorized representative of Applicant

SWORN AND SUBSCRIBED to before me on this the 27th day of April, 2023.

(Notary Seal)

Edmond R. McCarthy, Jr.  
Notary Public in and for the State of Texas  
My Commission Expires: 7-28-23

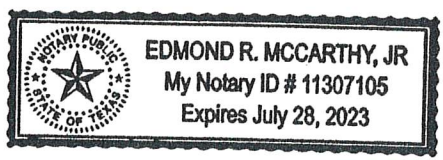

Well Locations		
Well	Latitude	Longitude
Corpora_1	30.967132° N	-96.681905° W
Corpora_2	30.930936° N	-96.703854° W
Corpora_3	30.931603° N	-96.720836° W
Corpora_4	30.934607° N	-96.709457° W
Corpora_5	30.939189° N	-96.647752° W
Corpora_6	30.928505° N	-96.667226° W
Corpora_7	30.941075° N	-96.664942° W
Corpora_8	30.862142° N	-96.648896° W
Corpora_9	30.866236° N	-96.641341° W
Corpora_10	30.828601° N	-96.637179° W
Corpora_11	30.830612° N	-96.633565° W
Corpora_12	30.784337° N	-96.560379° W
Corpora_13	30.784810° N	-96.554918° W



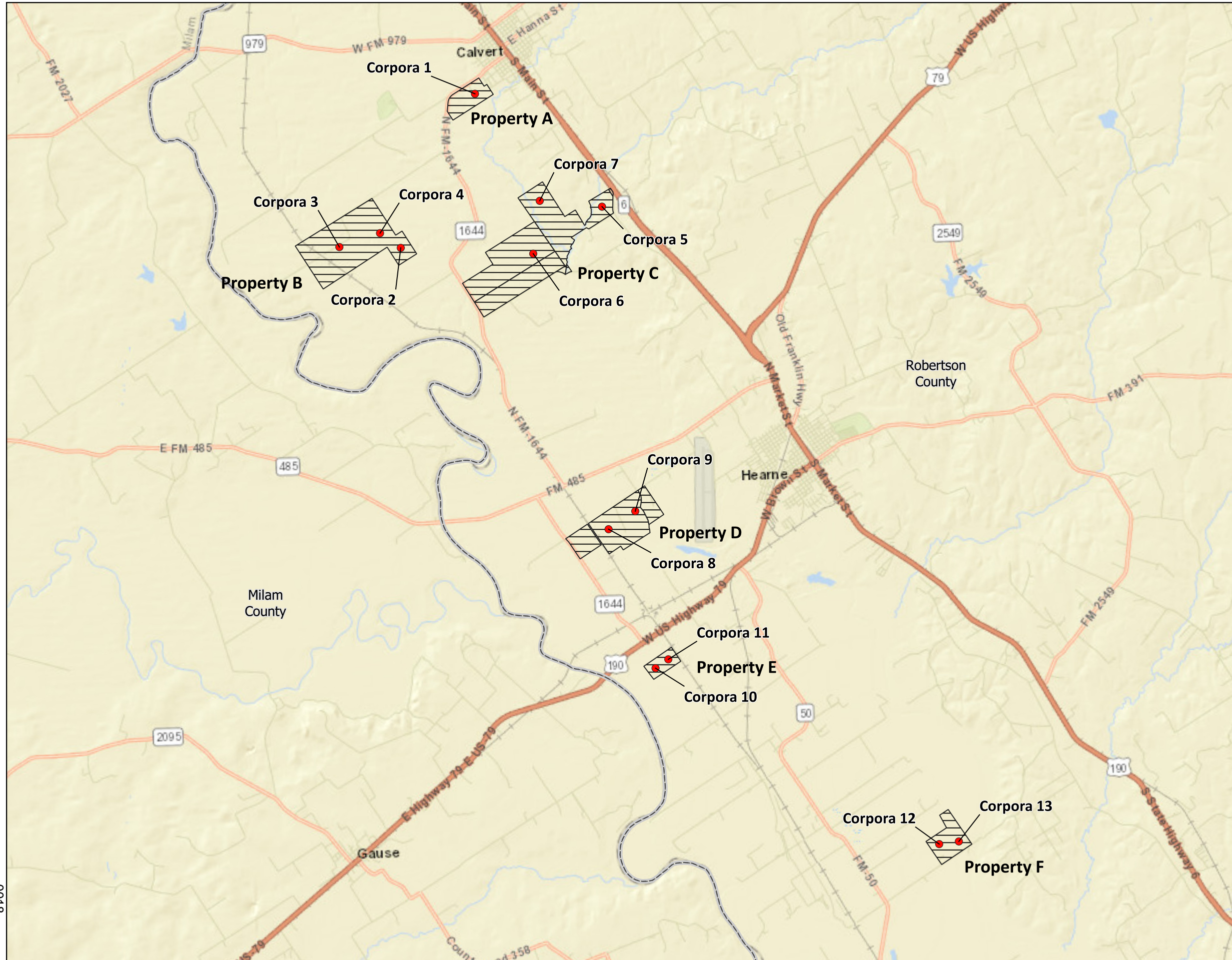

- Corpora Proposed Wells
- Corpora Listed Properties
- County Boundary

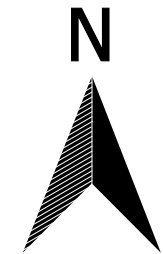

0 1 2 3 4 mi

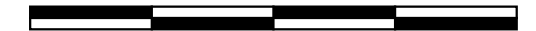

Scale 1:100,000

# Exhibit 1: Location Map



**AFFIDAVIT OF LEGAL RIGHT TO PRODUCE GROUNDWATER**

(Entity Form)

**BEFORE ME**, the undersigned authority, on this day personally appeared Sandra Ryan \_\_\_\_\_, who being duly sworn on her oath, says and deposes as follows:

"My name is Sandra C. Ryan \_\_\_\_\_. I am the Trustee (title) of The Sandra C. Ryan Trust \_\_\_\_\_ (name of entity) (hereinafter referred to as the "Applicant"). I have been authorized by The Trust \_\_\_\_\_ (name of entity) to give this affidavit. I am of sound mind, over eighteen (18) years of age, and have never been convicted of a felony or of a crime involving moral turpitude. My address is 13839 Zane Wallace Rd. \_\_\_\_\_, Hearne \_\_\_\_\_, Texas 77859 \_\_\_\_\_. I have personal knowledge of the facts stated herein, and they are true and correct.

1. I am submitting to the Brazos Valley Groundwater Conservation District ("District") an application for a drilling and/or operating permit on behalf of the Applicant for water wells located at \*See Attached \_\_\_\_\_.
2. Applicant has the legal authority to produce the groundwater associated with the land surface and the permit application for the well listed in #1 above, as required by District Rule 7.1(c).
3. Exhibit A, attached hereto, is the map that identifies the water rights to be legally controlled by the Applicant under District Rule 7.1(c) for the well listed in #1 above.
4. I have provided to the District documents that prove Applicant's right to own, control, or produce the groundwater rights associated with the permit application for the well listed in #1 above, as required by District Rule 7.1(c).
5. I have provided to the District documents, if any, that fully evidence all transfer(s) of Applicant's right to own, control, or produce the groundwater rights to another person/entity that are associated with the land surface and the permit application, as required by Rule 7. I(c). And I understand that I am required to provide such transfer documents as they occur in the future.
6. I understand that a permit may be amended or revoked if the groundwater rights or right to produce, related to a permit under Rule 7.1(c), are legally transferred to another person/entity.

**FURTHER AFFIANT SAYETH NOT."**

Signed Sandra C. Ryan  
Sandra C. Ryan, Individually  
and as Trustee of the Sandra Ryan Trust  
Authorized representative of Applicant

SWORN AND SUBSCRIBED to before me on this the 27<sup>th</sup> day of April, 2023.

(Notary Seal)

[Signature]

Notary Public in and for the State of Texas

My Commission Expires: 7-28-23

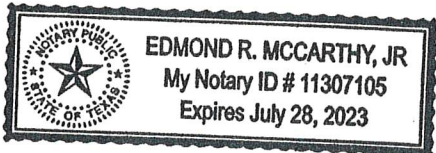

Well Locations		
Well	Latitude	Longitude
Corpora_1	30.967132° N	-96.681905° W
Corpora_2	30.930936° N	-96.703854° W
Corpora_3	30.931603° N	-96.720836° W
Corpora_4	30.934607° N	-96.709457° W
Corpora_5	30.939189° N	-96.647752° W
Corpora_6	30.928505° N	-96.667226° W
Corpora_7	30.941075° N	-96.664942° W
Corpora_8	30.862142° N	-96.648896° W
Corpora_9	30.866236° N	-96.641341° W
Corpora_10	30.828601° N	-96.637179° W
Corpora_11	30.830612° N	-96.633565° W
Corpora_12	30.784337° N	-96.560379° W
Corpora_13	30.784810° N	-96.554918° W



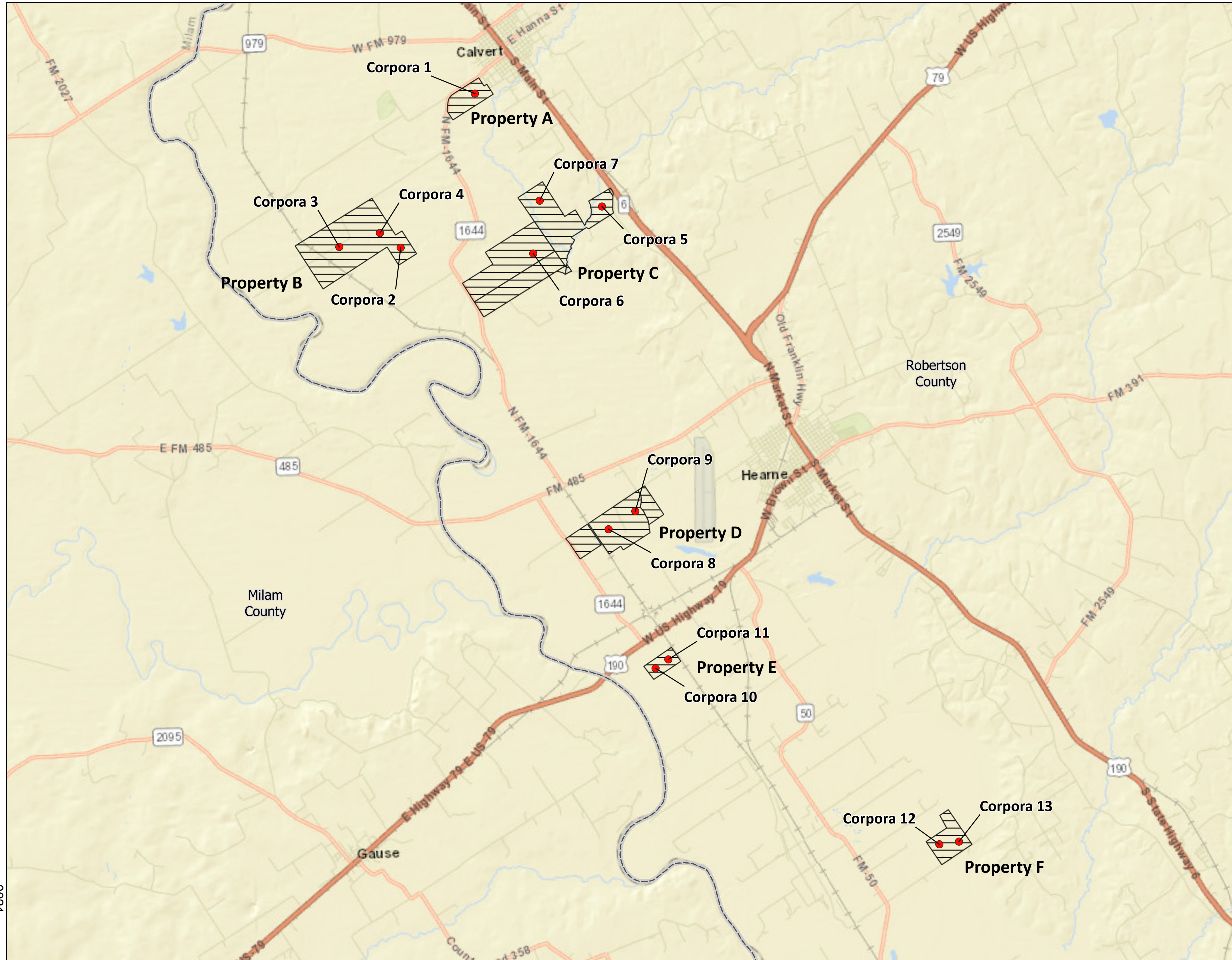

- Corpora Proposed Wells
- Corpora Listed Properties
- County Boundary

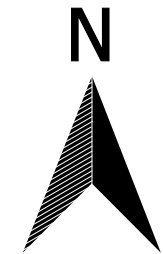

0 1 2 3 4 mi

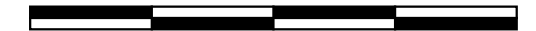

Scale 1:100,000

# Exhibit 1: Location Map

**Exhibit No. 1**

**Figure No. 2 – Map depicting the Locations of Corpora Well Nos. 1**

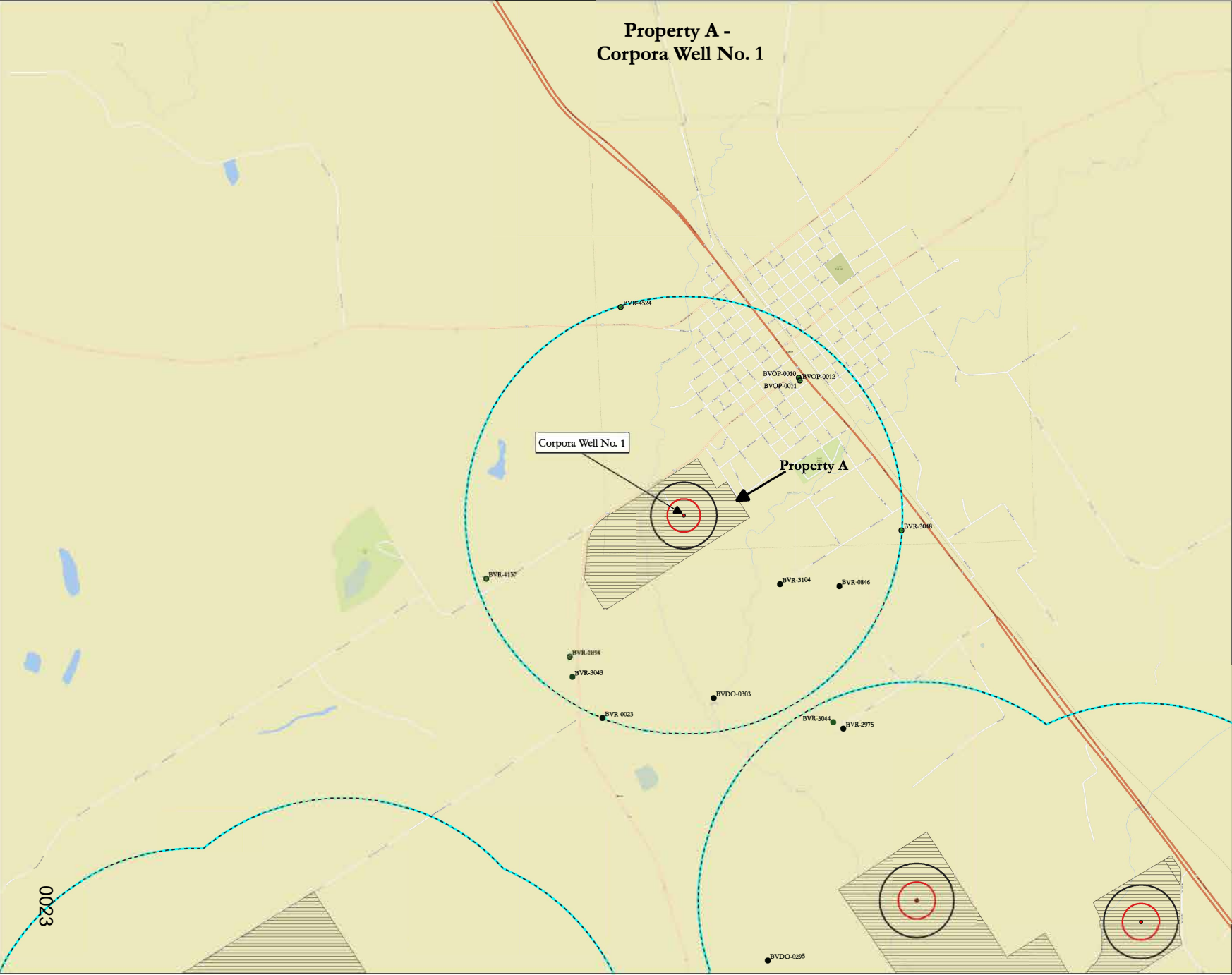

**Exhibit No. 1**

**Property A -  
Corpora Well No. 1**

- Corpora Proposed Well
- - Red Buffer indicates property boundary spacing requirement
- - Black Buffer indicates Simsboro well spacing requirement
- BVGCD Registered Simsboro Well
- 1 Mile Buffer
- ▨ Corpora Property Boundary

*\*All Proposed Wells to be Completed in the Simsboro Aquifer*



0 1,000 2,000 ft  
Scale 1:12,000

**Figure 2:  
BVGCD Wells  
Within 1 Mile**

**Exhibit No. 2**

**Figure No. 2-A – Map depicting the Locations of Corpora Well Nos. 2, 3 & 4**

# Exhibit No. 2

Property B -  
Corpora Wells No. 2 - 4

- Corpora Proposed Well
- - Red Buffer indicates property boundary spacing requirement
- - Black Buffer indicates Simsboro well spacing requirement
- BVGCD Registered Simsboro Well
- 1 Mile Buffer
- ▨ Corpora Property Boundary

*\*All Proposed Wells to be Completed in the Simsboro Aquifer*

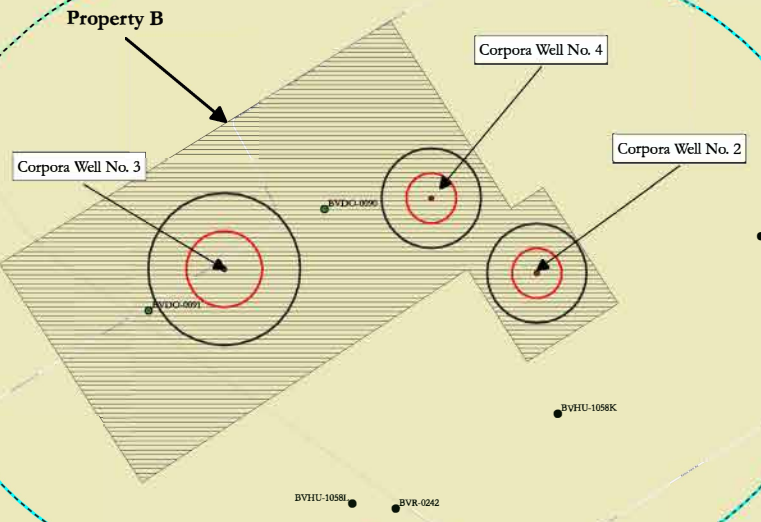

0025

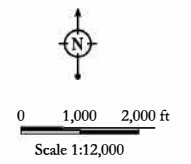

Figure 2-A:  
BVGCD Wells  
Within 1 Mile



**Exhibit No. 3**

**Figure No. 2-B – Map depicting the Locations of Corpora Well Nos. 5, 6 & 7**

Exhibit No. 3



- Corpora Proposed Well
- - Red Buffer indicates property boundary spacing requirement
- - Black Buffer indicates Simsboro well spacing requirement
- BVGCD Registered Simsboro Well
- 1 Mile Buffer
- ▨ Corpora Property Boundary

*\*All Proposed Wells to be Completed in the Simsboro Aquifer*



0 1,000 2,000 ft  
Scale 1:12,000

Figure 2-B:  
BVGCD Wells  
Within 1 Mile



0027

**Exhibit No. 4**

**Figure No. 2-C – Map depicting the Locations of Corpora Well Nos. 8 & 9**



Property D -  
Corpora Wells No. 8 and 9

- Corpora Proposed Well
- - Red Buffer indicates property boundary spacing requirement
- - Black Buffer indicates Simsboro well spacing requirement
- BVGCD Registered Simsboro Well
- 1 Mile Buffer
- ▨ Corpora Property Boundary

*\*All Proposed Wells to be Completed in the Simsboro Aquifer*

Corpora Well No. 9

Corpora Well No. 8

Property D

0029



0 1,000 2,000 ft  
Scale 1:12,000

Figure 2-C:  
BVGCD Wells  
Within 1 Mile



**Exhibit No. 5**

**Figure No. 2-D – Map depicting the Locations of Corpora Well Nos. 10 & 11**

Property E -  
Corpora Wells No. 10 and 11

- Corpora Proposed Well
- - Red Buffer indicates property boundary spacing requirement
- - Black Buffer indicates Simsboro well spacing requirement
- BVGCD Registered Simsboro Well
- 1 Mile Buffer
- ▨ Corpora Property Boundary

*\*All Proposed Wells to be Completed in the Simsboro Aquifer*

Corpora Well No. 11

Corpora Well No. 10

Property E

0031



0 1,000 2,000 ft

Scale 1:12,000

Figure 2-D:  
BVGCD Wells  
Within 1 Mile





**Exhibit No. 6**

**Figure No. 2-C – Map depicting the Locations of Corpora Well Nos. 12 & 13**

Property F -  
Corpora Wells No. 12 and 13

- Corpora Proposed Well
- - Red Buffer indicates property boundary spacing requirement
- - Black Buffer indicates Simsboro well spacing requirement
- 1 Mile Buffer
- ▨ Corpora Property Boundary

*\*All Proposed Wells to be Completed in the Simsboro Aquifer*

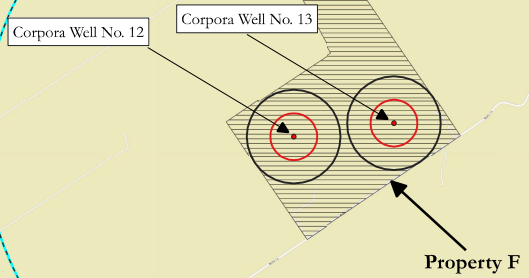

0033



0 1,000 2,000 ft  
Scale 1:12,000

Figure 2-E:  
BVGCD Wells  
Within 1 Mile