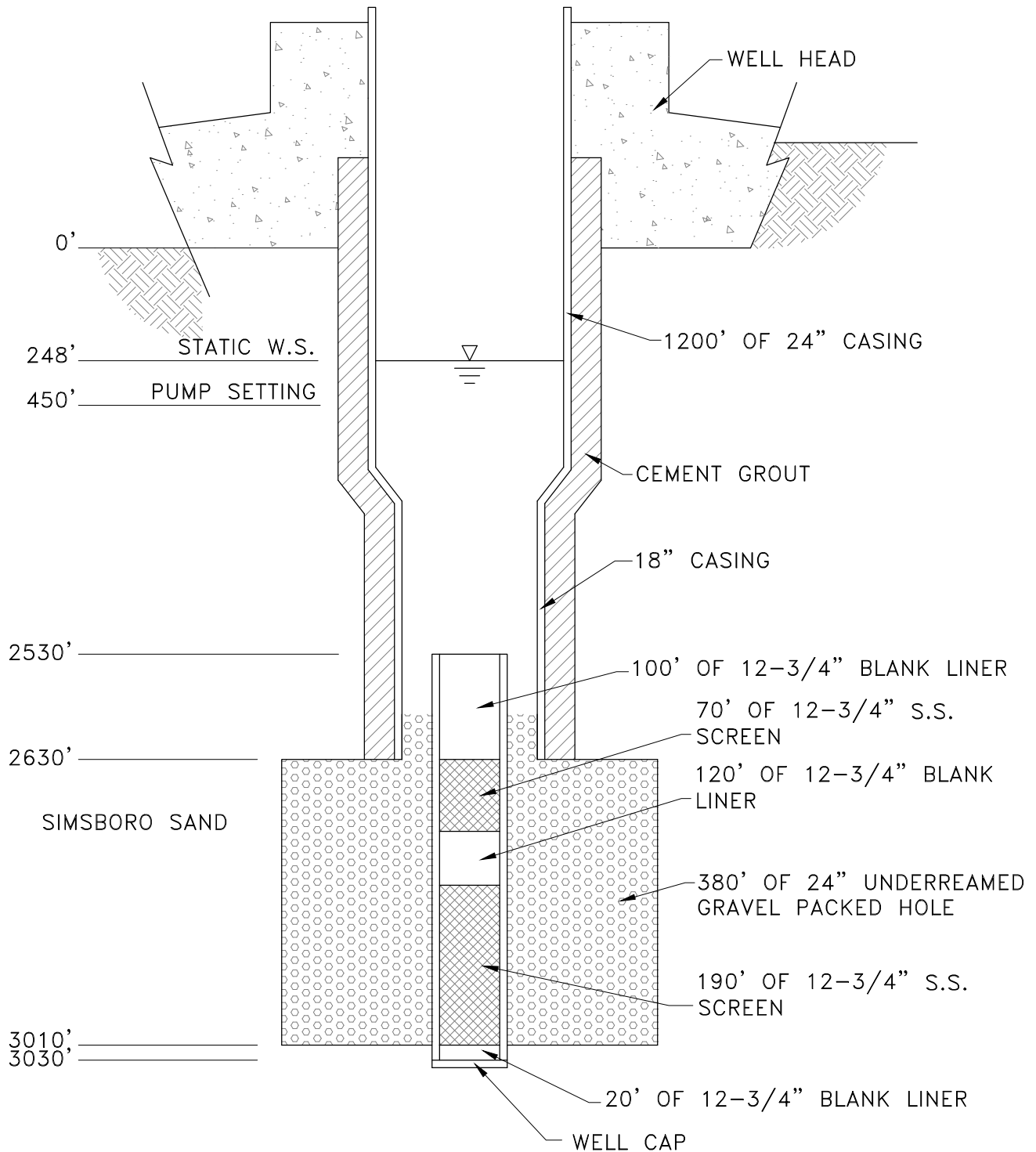

EXHIBIT 3
PRELIMINARY WELL DETAIL

DEPTH (FT.)



TEXAS REGISTERED ENGINEERING FIRM
TBPE F-1741

505 Padon
Longview, Texas 75606
T. 903-553-0500
www.cpyi.com
TBPE # F-1741

WICKSON CREEK SUD
WATER WELL NO. 9

PRELIMINARY
SIMSBORO WELL DETAIL

EXHIBIT 3